

INSTALLATION SHEET

CARGOMAX™

THE ULTIMATE IN MAXIMUM STORAGE

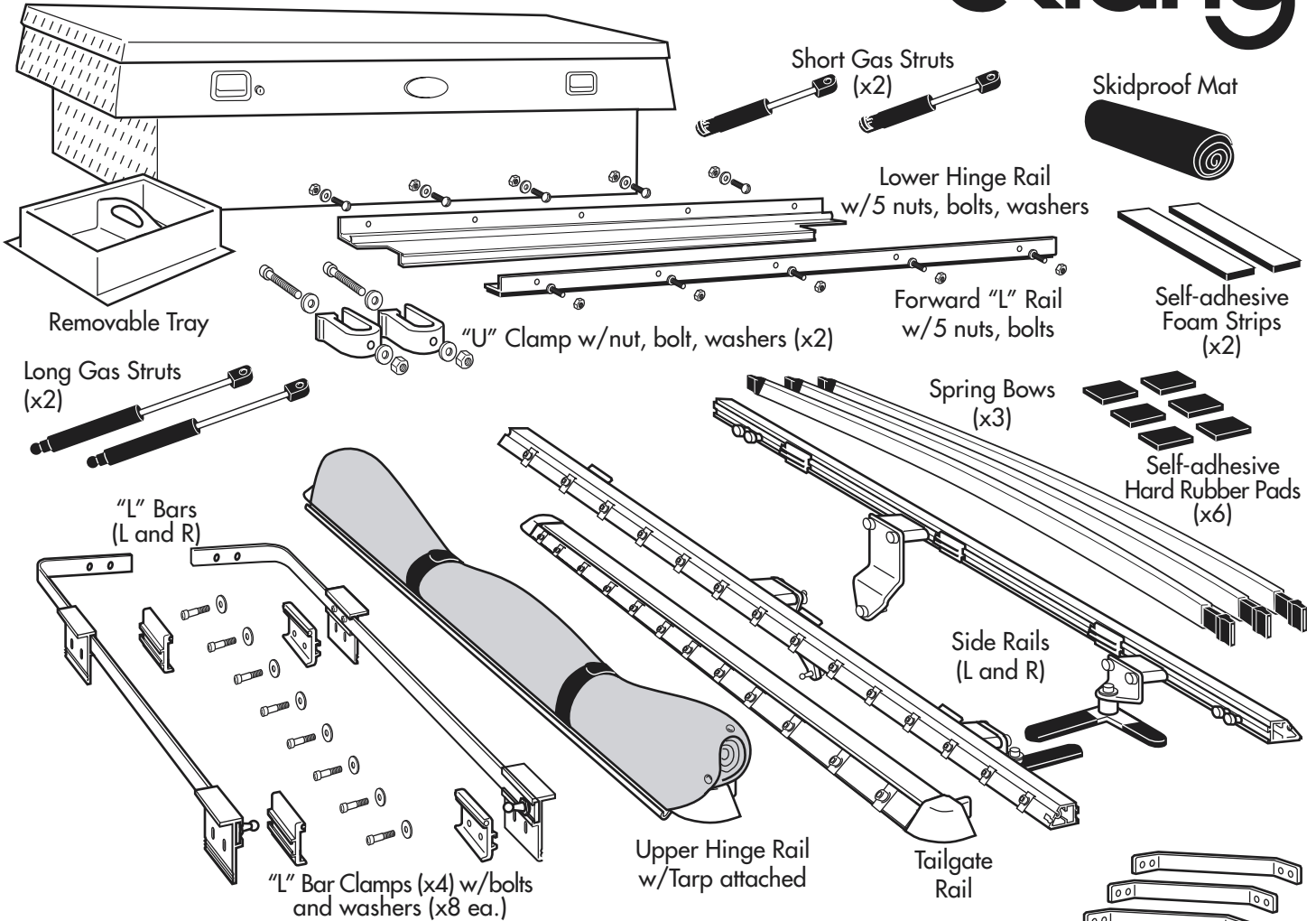

MISSING PARTS???

Call Extang at **1-800-877-2588**

Any and all needed parts will be shipped to you directly.

(DO NOT return whole kit to store)

PARTS INCLUDED IN YOUR KIT. You may want to lay them out in this manner for accessibility.



Extang Corporation
1901 E. Ellsworth Rd.
Ann Arbor, MI 48108
734 677-0444, Fax: 734 677-8409

Visit us at:
www.extang.com

Item No. 0034-0202 RH Install in U.S.A.

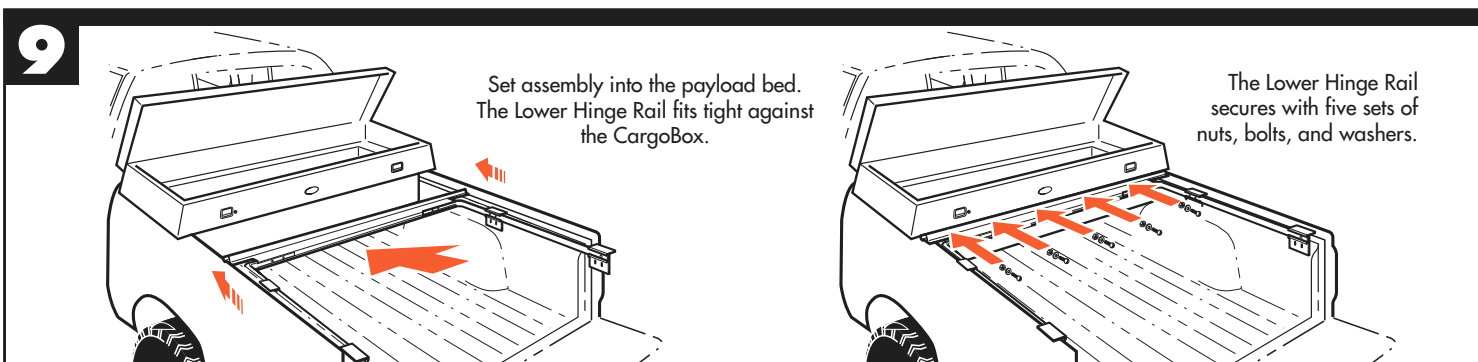
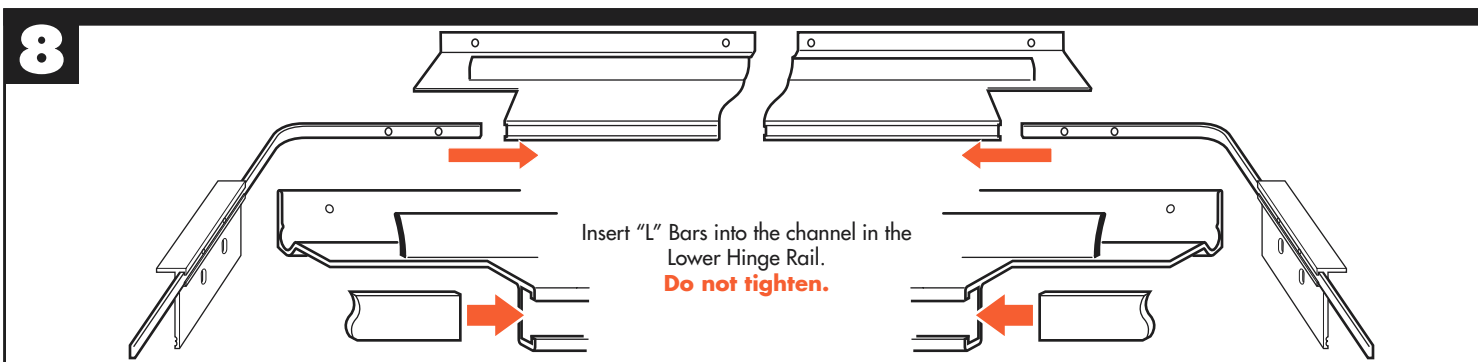
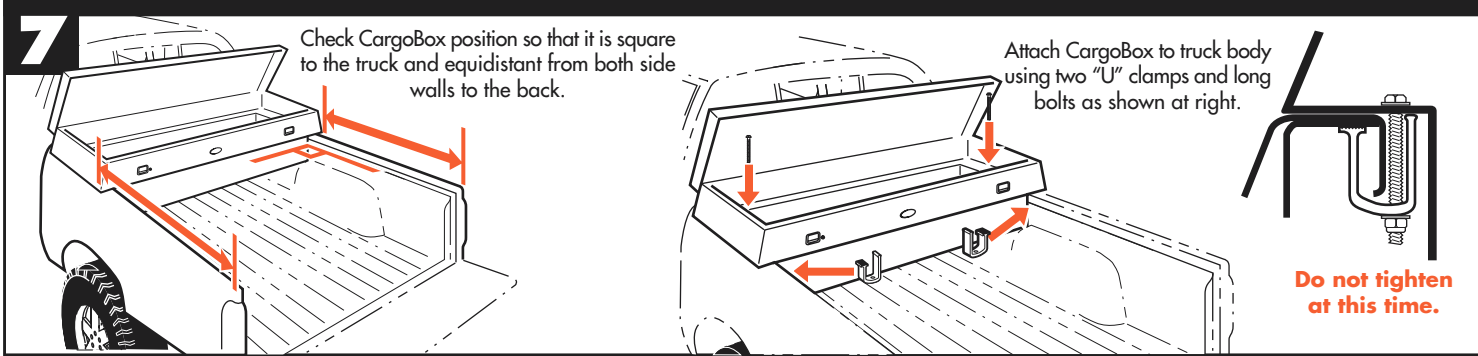
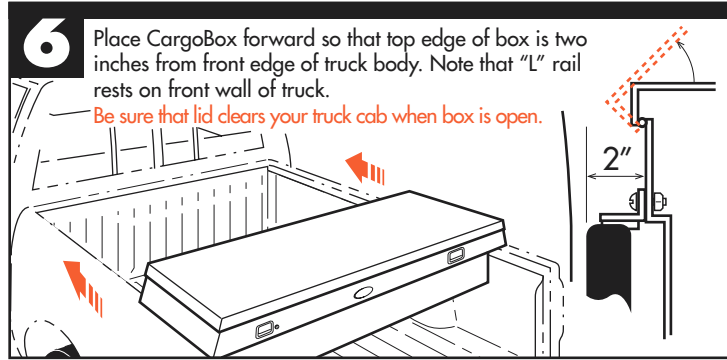
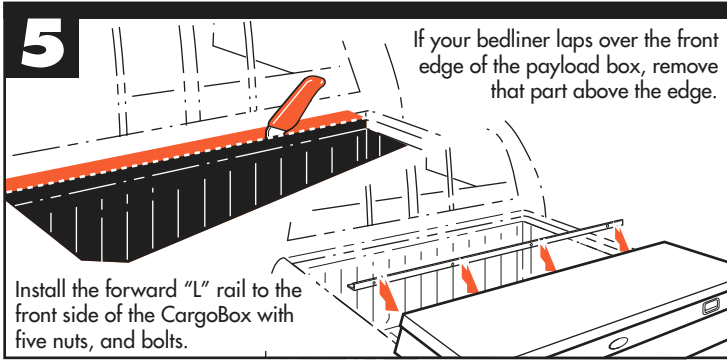
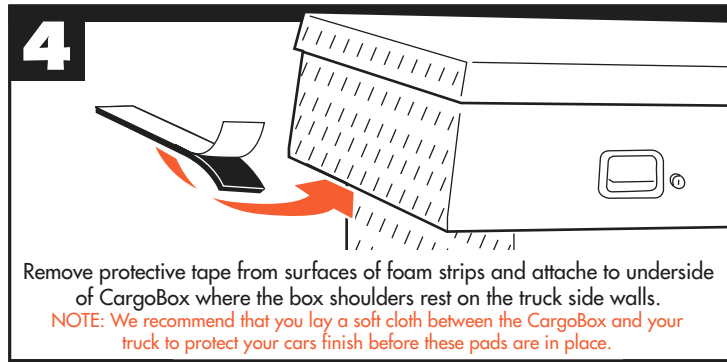
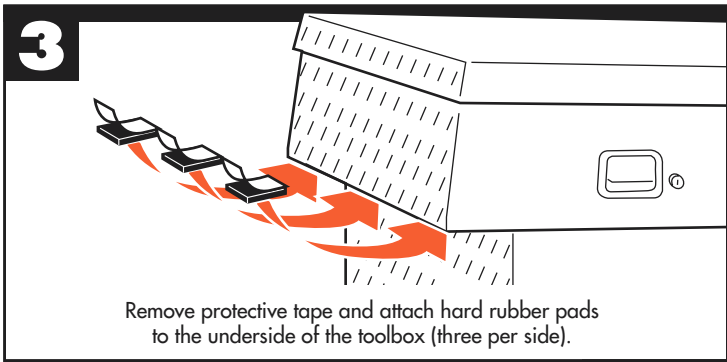

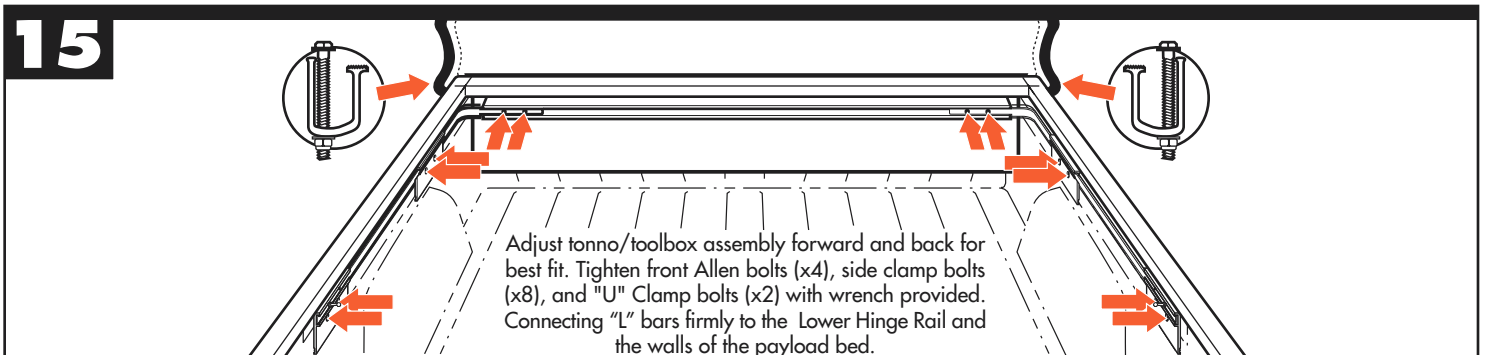
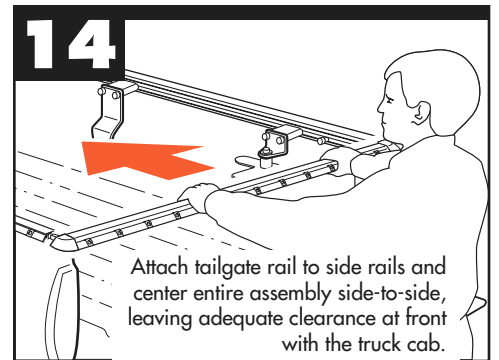
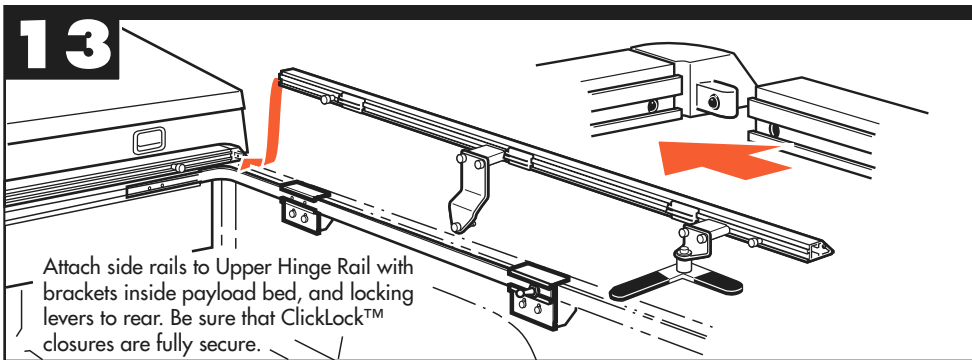
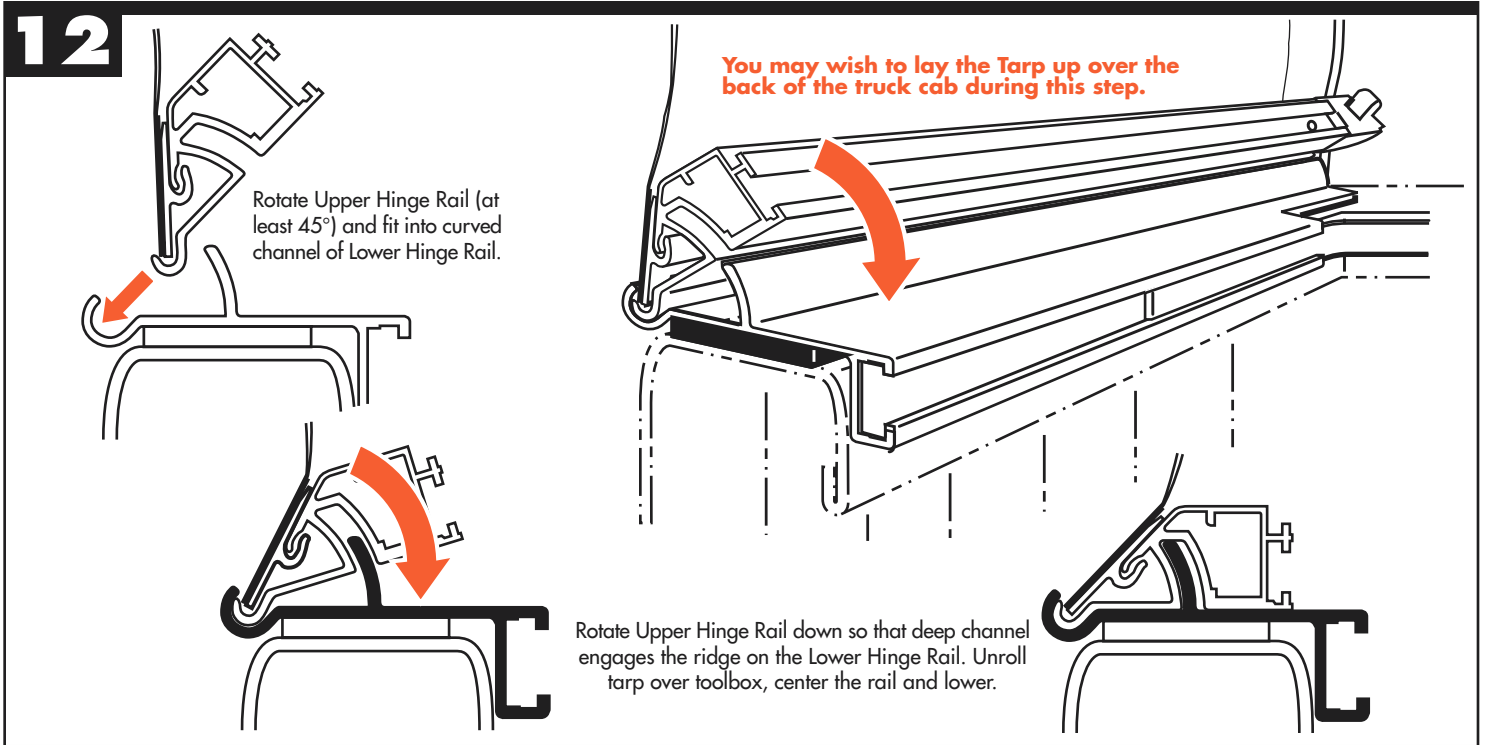
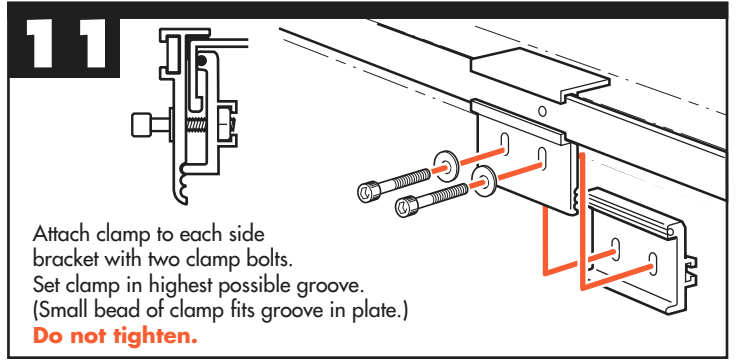
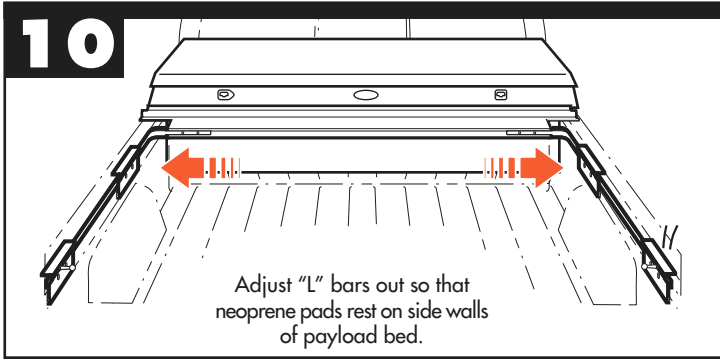

16

Remove each pair of corner small Allen bolts on ends of rails and insert diagonal bracket between them. **Do Not Tighten at this time.**

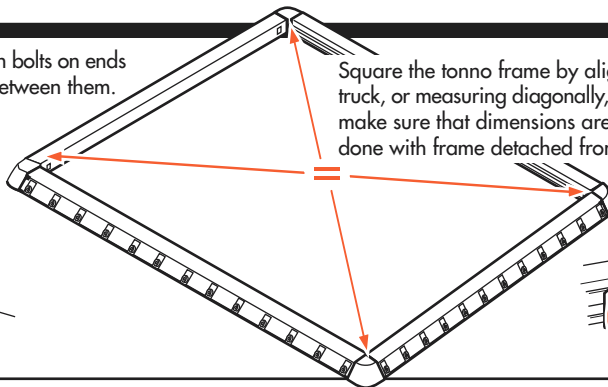
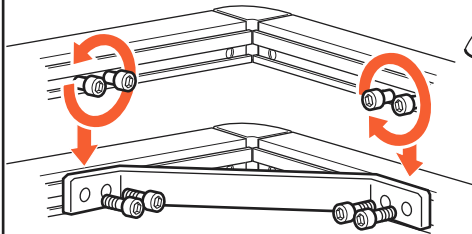

Square the tonno frame by aligning to side rails of truck, or measuring diagonally, corner-to-corner, and make sure that dimensions are equal. (This can be done with frame detached from truck.)

With tonno frame squared, retighten the corner Allen bolts.

Note: Be sure that all corner members are seated inside of rails.

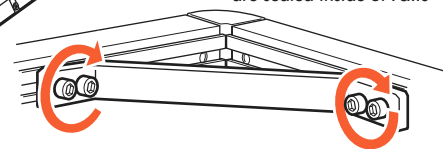

17

Frame Locking Lever must be parallel to side rail when opening and closing tonno.

Locking Lever is secure when positioned at right angle to, and engaged with side wall.

Locking Levers come from the factory ready to fit your truck.

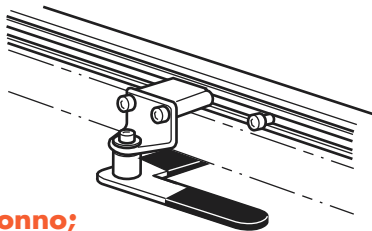
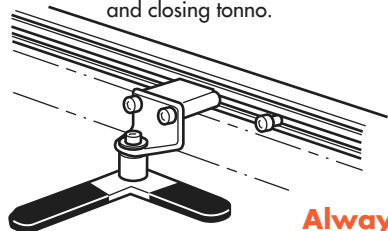

If lever doesn't fit snugly under side, you can restack bushing to get a better fit.

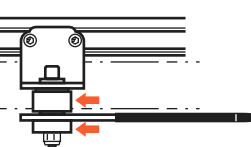

Always latch tonno; wind may open tonno, even when truck is stationary.

18

Insert bow onto top or bottom peg, (Top peg for performance, Bottom for good looks.)

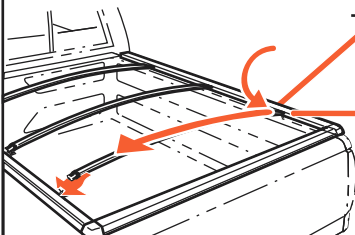
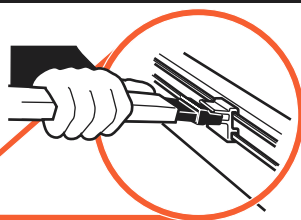

Ends are spring loaded for easy installation. Push and hold on spring end and let the other end slide on with the spring action.

Upper Peg

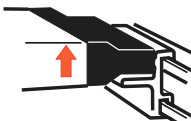

or

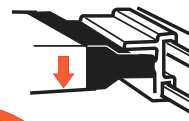

Lower Peg

SPECIAL FEATURE: Two pegs offer two height adjustments. Note: Bow End does not fit between pegs.

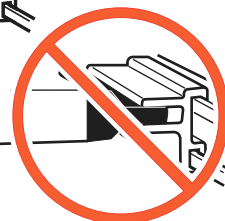

Not

Do Not Place Between the Pegs

19

Place sockets of Gas Strut over ball joints on each bracket (cylinder-end attaches to truck). Cylinder (round) socket should press easily over the lower ball. Press retainer of upper socket into the ball to lock securely in place. To remove cover from truck, disengage Gas Strut at lower joint.

NOTE: Round socket will release with hand pressure. Do not remove strut from tonno frame.

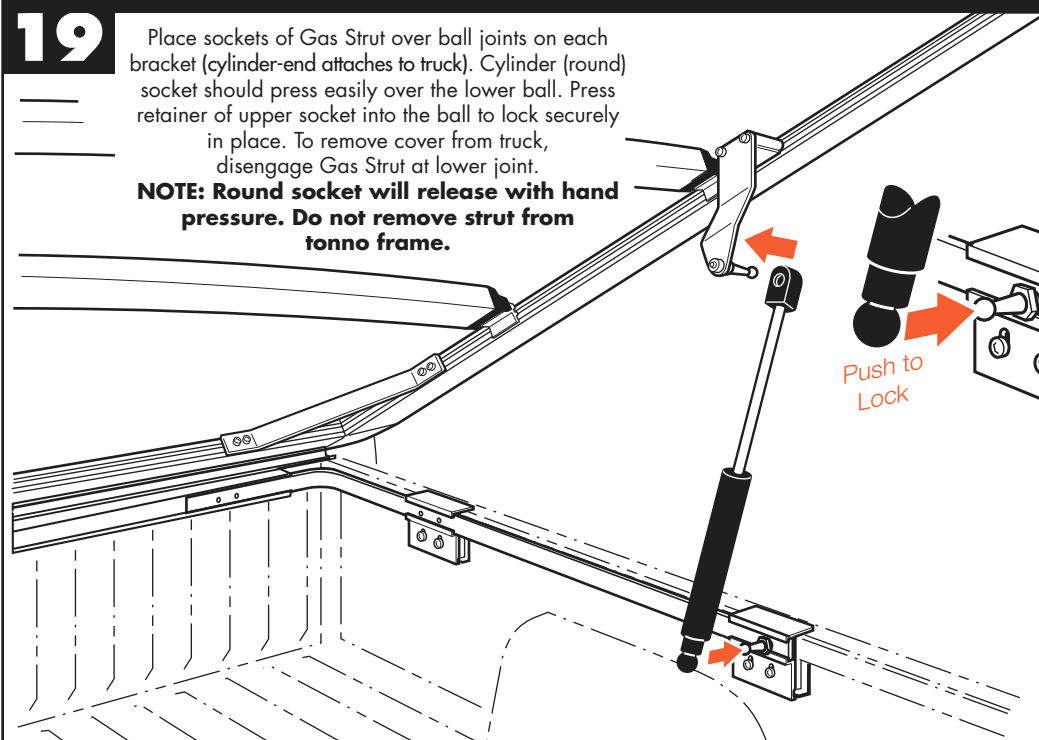

Push to Lock

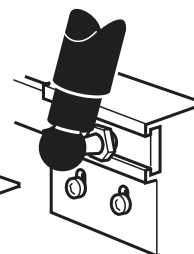
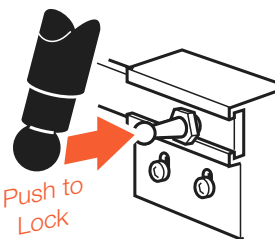

Pull to Release

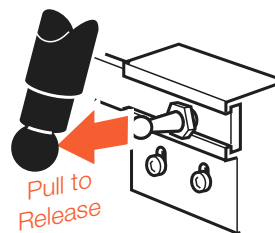

20

Start at Corners Attach tarp by starting at the corners, and snap in place.

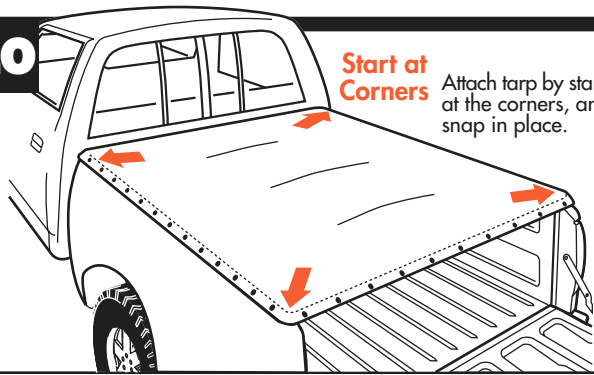

SPECIAL FEATURE

Weather-adjustable Snaps

When it's time to change, just bring the tonno inside!

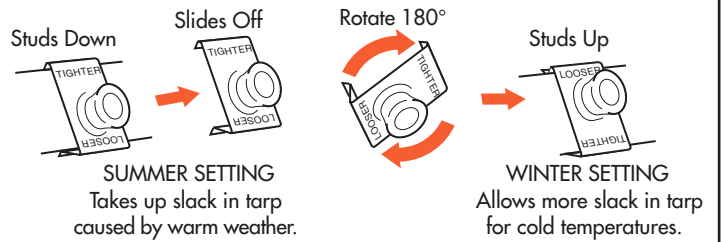

Operating Your CargoBox™

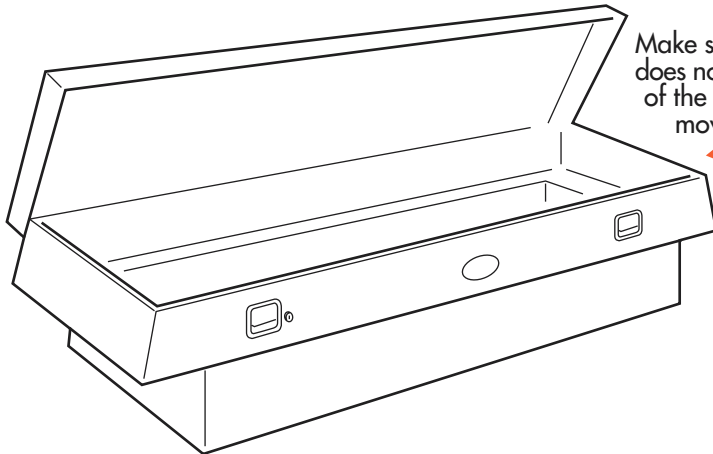

Make sure the contents of your toolbox does not exceed the height of the inside of the box. Small or loose items may move around during transport.

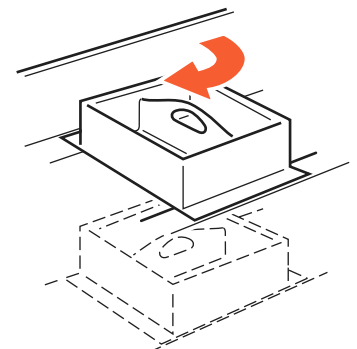

Tray can be rotated to store at the bottom of the CargoBox

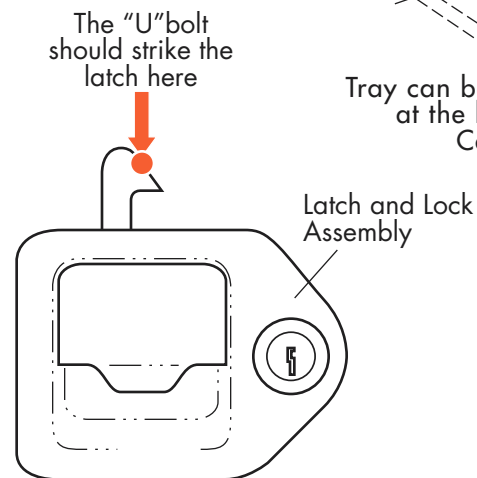
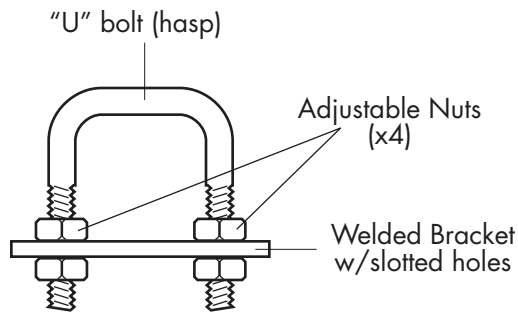

During operation, truck beds can flex up to an inch out of normal position. Due to that flex, and to differences in alignment normal to truck bed manufacturing, it may be necessary to periodically adjust the latches in the CargoBox.

The "U" bolt hasp should strike in the proper part of the latch as shown. You can adjust it easily by loosening the nuts on the "U" bolt itself, repositioning it properly and retightening the bolt securely to its bracket. The "U" bolt can be adjusted in and out as well as side to side.

You should inspect the latch and "U" bolt periodically, as you use your truck.

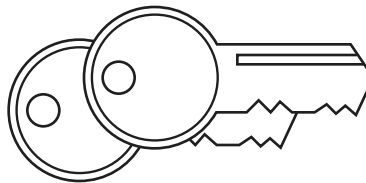

Your Extang CargoBox comes with two keys. Please note your CargoBox key number. You may want to make a duplicate for safekeeping.

NOTE: Toolbox keys are easily duplicated and aluminum truck boxes can be jimmed open.

Extang CargoBoxes are intended for carrying tools and other articles. Do not rely on these boxes as a secure place to store valuable items.



Extang Corporation, 1901 E. Ellsworth Rd., Ann Arbor, MI 48108, 734 677-0444, Fax: 734 677-8409, Visit us at: www.extang.com

Operating Your CargoMax™ Tonno

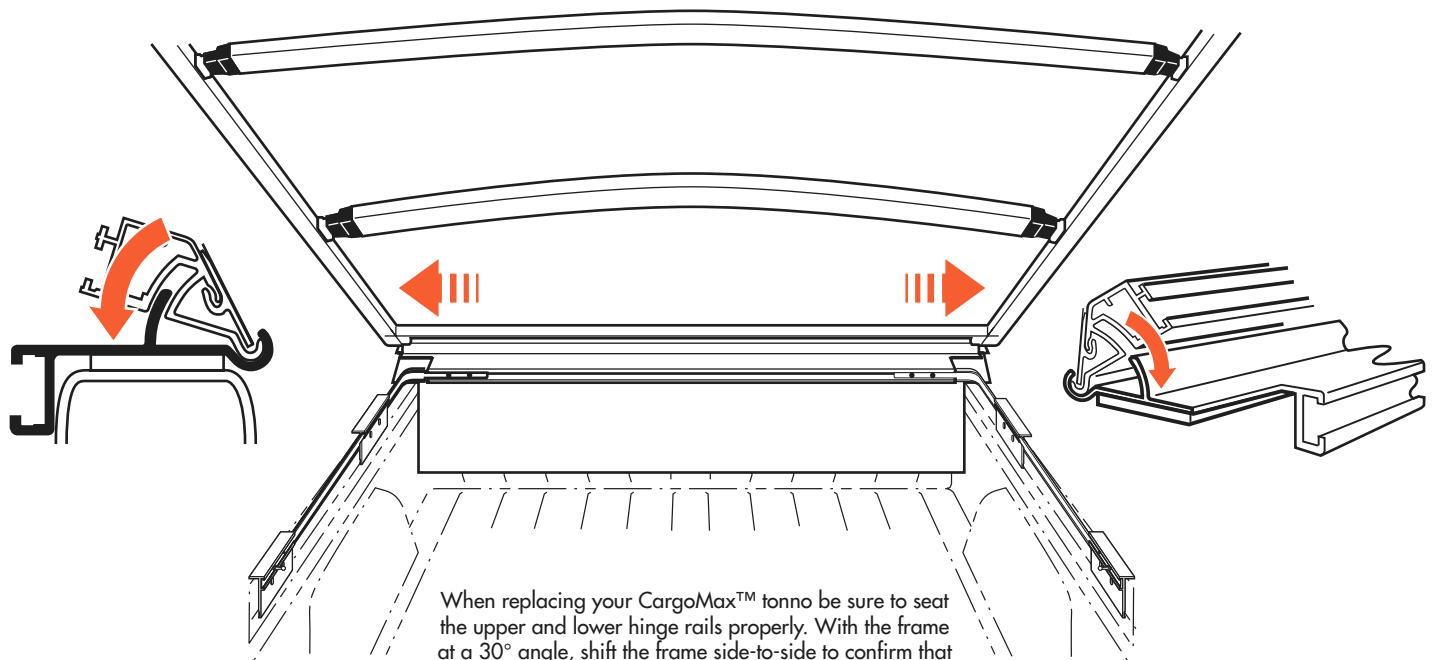

When replacing your CargoMax™ tonno be sure to seat the upper and lower hinge rails properly. With the frame at a 30° angle, shift the frame side-to-side to confirm that the curved ridge on the lower hinge rail is located between the tonno frame corner caps.

**When in the proper position, the frame should freely translate about 1/8".
If not, raise the frame and seat it again.**

CAUTION!

**High winds may catch the tonno cover and cause it to open if not latched.
Be very careful operating tonno in windy conditions.
Cover should always be latched when truck is in motion.
Extang CargoBoxes are intended for carrying tools and other articles.
Do not rely on these boxes as a secure place to store valuable items.**

Quick and Easy Removal

- Step 1- Lift and hold cover while releasing the clip on the gas strut. (Note: Do not remove clip).
- Step 2- Rotate the cover upward past 45° and lift out of the quick-hinge front rail system.
- Step 3- Slide the off the lower hinge rail.

Quick and Easy Reattachment

- Step 1- Lift cover as a unit and drop front edge into the quick-hinge front rail system groove. Be careful that locking tongue (vertical web) is between both corners. There is about 1/8' total clearance on the ends. Slowly and gently rotate downward. **DO NOT FORCE! IT SHOULD FALL INTO PLACE!!**
Note: Frame should slide side-to-side about 1/8" freely, If hinge is tight, something is wrong, you are most likely not centered.
- Step 2- Reattach the gas struts with body on bottom in open position. Drop cover and latch both sides securely.