

See Part Descriptions on Back

NOTE: To order, xxx represents the 3-digit application # (vehicle type) following the 1- or 2-digit prefix, as referenced on the vehicle application list or sales receipt. Or call our Customer Service Department at 1-800-877-2588 for assistance.

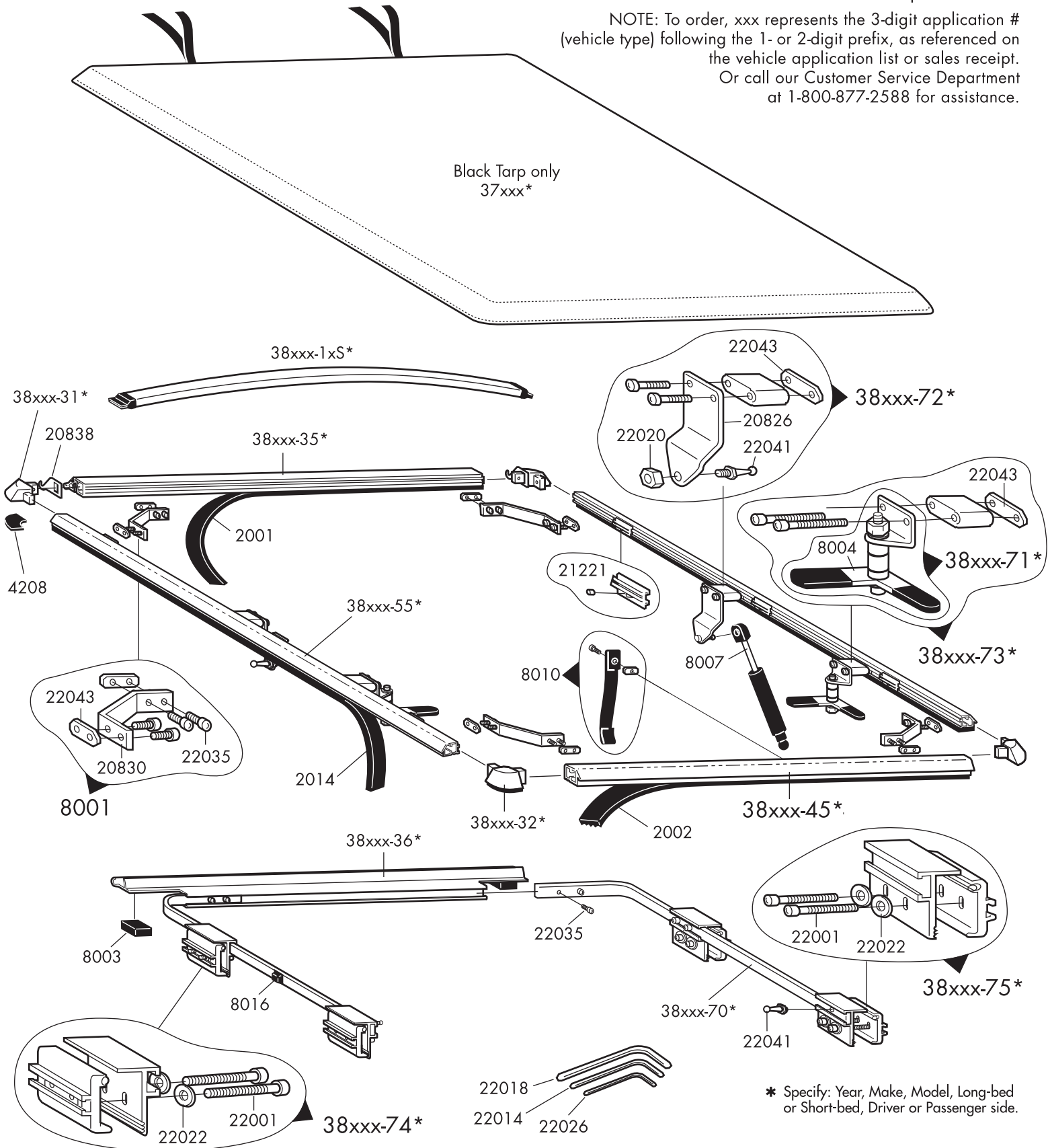

* Specify: Year, Make, Model, Long-bed or Short-bed, Driver or Passenger side.

NOTE: To order, xxx represents the 3-digit application # (vehicle type) following the 1- or 2-digit prefix, as referenced on the vehicle application list or sales receipt. Or call our Customer Service Department at 1-800-877-2588 for assistance.

- | | | | |
|-------------------|--|------------------|-----------------------------|
| 37xxx* | Black FullTilt Replacement Tarp | 38xxx-74* | Front Clamp Assembly (1) |
| 38xxx-10S* | Cab Bow w/Bow Ends (1) | 22001 | 5/16-138x13/4 SHCS (1) |
| 38xxx-11S* | Center Bow w/Bow Ends (S Bed) (1) | 22022 | 1/4" Washer (1) |
| 38xxx-12S* | Cab Center Bow w/Bow Ends (L Bed) (1) | 38xxx-75* | Rear Clamp Assembly (1) |
| 38xxx-13S* | Tail Center Bow w/Bow Ends (L Bed) (1) | 22001 | 5/16-18x13/4 SHCS (1) |
| 38xxx-14S* | Tail Bow w/Bow Ends (1) | 22022 | 1/4" Washer (1) |
| 38xxx-31* | Front Replacement Corner (2) | 8001 | Corner Brace Assembly (1) |
| 38xxx-32* | Rear Replacement Corner (2) | 20830 | Corner Brace |
| | 4208 Replacement Corner Pads (4) | 22043 | Weld Nut (1) |
| 38xxx-35* | Upper Pivot (Cab) Rail Assembly | 22035 | 1/4"-20x3/8" SHCS (1) |
| | 2001 Cab Rail Foam Strip (30 ft.) | 8007 | Gas Shock (1) |
| | 20838 Cab Rail Hinge Lock (1) | 8010 | Pull-Down Strap w/Fasteners |
| 38xxx-36* | Lower Pivot Rail | Miscellaneous | |
| | 8003 Pivot Rail Foam Pad (2) | 22014 | 3/16" Hex Key (1) |
| 38xxx-45* | Tailgate Rail Assembly | 22018 | 1/4" Hex Key (1) |
| | 2002 Tailgate Foam Strip (6 ft.) | 22026 | 3/32" Hex Key (1) |
| 38xxx-55* | Side Rail Assembly (1) | | |
| | 2014 Side Rail Foam Strip (8 ft.) | | |
| | 21221 Bow Clip w/Screw (2) | | |
| 38xxx-70* | "L" Rod (1) | | |
| | 8016 "L" Rod Bumper (1) | | |
| 38xxx-72* | Shock Stand-off Assembly (1) | | |
| | 20826 Shock Stand-off Bracket (1) | | |
| | 22020 5/16 Nylon Nut | | |
| | 22041 10mm Ball Stud (1) | | |
| | 22043 Weld Nut (1) | | |
| 38xxx-73* | Latch Stand-off Assembly (1) | | |
| | 38xxx-71* Latch Assembly (1) | | |
| | 8004 Latch w/Sleeves | | |
| | 22043 Weld Nut (1) | | |

* Specify: Year, Make, Model, Long-bed or Short-bed, Driver or Passenger side.